

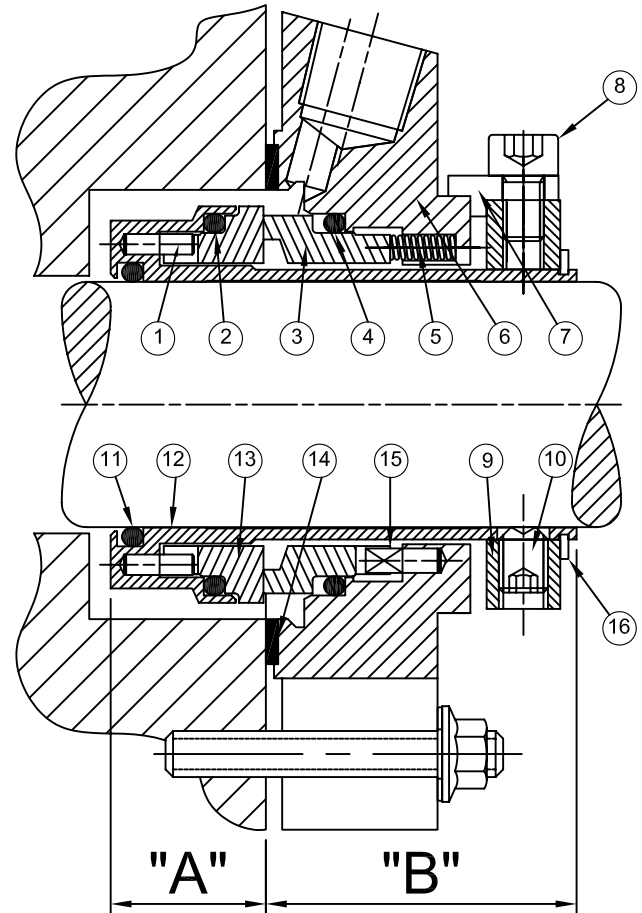

INSTALLATION INSTRUCTION

S141 / S145 Single Cartridge Seal

Installation Size		
Size	A	B
24mm - 70mm	38mm	19mm
73mm - 100mm	41.5mm	20.5mm



Pre-Installation Checks.

- (i) Shaft Outside Diameter is within tolerance $\pm 0.05\text{mm}$.
- (ii) Shaft run out $< 0.1\text{mm}$ T.I.R.
- (iii) Shaft end float $< 0.13\text{mm}$.
- (iv) Fluid seal can be obtained on the Stuffing Box face.
- (v) There are no sharp edges over which the seal 'O' Ring (11) must pass.

Installation instructions.

1. Lubricate the shaft with silicon grease.
2. Slide the seal onto the shaft.
3. Assemble rest of equipment in final running position, after pump assembly.
4. Slide seal into position. Fit washers in all cases and tighten Gland Nuts down firmly.
5. Equally tighten the Drive Screws (10) down onto the shaft.
6. Remove setting clips (7).
7. Spin the shaft by hand. Listen and feel for any shaft binding, etc.
8. Retain clips and clip screws for future use.
9. Ensure the pump is primed prior to start up.

DECLARATION OF INCORPORATION

This Mechanical seal must not be put into service until the relevant machinery into which it is incorporated has been declared to be in conformity with the provisions of the Machinery Directive.

ITEM	DESCRIPTION	MATERIAL	ITEM	DESCRIPTION	MATERIAL
1	Pin	Stainless Steel	9	Drive Collar	Stainless Steel
2	Rotary O Ring	Viton / EPR / Kalrez / Aflas	10	Drive Screws	Stainless Steel
3	Stationary Face	TC / SiC / SSiC	11	Static O Ring	Viton / EPR / Kalrez / Aflas
4	Dynamic O Ring	Viton / EPR / Kalrez / Aflas	12	Sleeve	Stainless Steel
5	Springs	Stainless Steel / Alloy 276	13	Rotary Face	Carbon / TC / SiC / SSiC
6	Gland	Stainless Steel	14	Gasket	PTFE / CNAF / GRAPH
7	Centering Clips	Hard Plastic	15	Pin	Stainless Steel
8	Clip Screws	Stainless Steel	16	Snap Ring	Stainless Steel