



SS13

Stationary Seat

Materials

Stationary - Carbon
Elastomer - NBR, EPDM, Viton

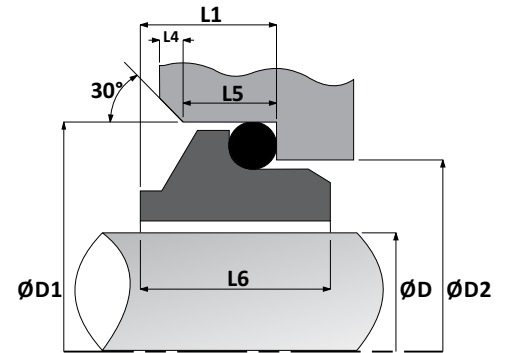

Shaft ØD	ØD1	ØD2	L1	L4	L5	L6
10	19.2	15.5	7.1	1.2	3.8	9.0
12	21.6	17.5	7.6	1.2	3.8	10.0
14	24.6	20.5	7.6	1.2	3.8	10.0
15	24.6	20.5	8.6	1.2	3.8	11.0
16	28.0	22.0	9.0	1.5	3.8	11.5
18	30.0	24.0	10.0	1.5	5.0	12.5
20	35.0	29.5	9.5	1.5	5.0	12.5
22	35.0	29.5	9.5	1.5	5.0	12.5
24	38.0	32.0	9.5	1.5	5.0	12.5
25	38.0	32.0	9.5	1.5	5.0	12.5
28	42.0	36.0	11.0	1.5	5.0	14.0
30	45.0	39.2	11.0	1.5	5.0	14.0
32	48.0	42.2	11.0	1.5	5.0	14.0
33	50.0	44.2	11.5	1.5	5.0	14.5
35	52.0	46.2	11.5	1.5	5.0	14.5
38	55.0	49.2	11.5	1.5	5.0	14.5
40	58.0	52.2	11.5	1.5	5.0	14.5
43	62.0	53.3	14.3	2.0	6.0	17.0
45	64.0	55.3	14.3	2.0	6.0	17.0
48	68.4	59.7	14.3	2.0	6.0	17.0
50	69.3	60.8	14.3	2.0	6.0	17.0
53	72.3	63.8	14.3	2.0	6.0	17.0
55	75.4	66.5	15.3	2.0	6.0	18.0
58	78.4	69.5	15.3	2.0	6.0	18.0
60	80.4	71.5	15.3	2.0	6.0	18.0
63	83.4	74.5	15.3	2.0	6.0	18.0
65	85.4	76.5	15.3	2.0	6.0	18.0
68	91.5	82.7	16.0	2.0	6.0	19.0
70	92.0	83.0	15.3	2.0	6.0	18.0
75	99.0	90.2	15.3	2.0	6.0	18.0
80	104.0	95.2	16.3	2.0	6.0	19.0
85	109.0	100.2	16.3	2.0	6.0	19.0
90	114.0	105.2	16.3	2.0	6.0	19.0
95	120.3	111.6	17.3	2.0	6.0	20.0
100	123.3	114.5	17.3	2.0	6.0	20.0